

# INSTRUCTIONS

## Prodigy Plus Flake and Nugget - Ice Type Conversion Kit

\*Conversion kits fit all Prodigy Plus flaker and nugget units manufactured August 2020 or later (NH, NS, and FS models)\*

### Remove Existing Extruder:

1. Shut off power to machine at wall or at breaker.
2. Remove front panel. The top and right panels may also be removed for easier access.
3. Push bail clamp back and remove ice chute cover. Set aside for reassembly.
4. Unscrew and remove ice sweep. Set sweep bolt aside for reassembly.
5. Remove ice chute body and insulation collar.
6. Remove bail clamp and set aside for reassembly.
7. Unscrew all 4 1/4" allen head screws holding extruder to evaporator and set aside for reassembly.
8. Remove extruder from evaporator, being careful to avoid disturbing auger. If the auger is disturbed, the water seal must also be replaced (02-0929-03).

**Note:** On any unit over 1 year old, scale buildup will likely make removing the extruder without disturbing the auger difficult. In this case, the auger should be pulled and the water seal replaced.

### Install New Extruder:

9. Carefully place new extruder assembly over the auger and onto evaporator.
10. Secure extruder assembly to evaporator using all 4 1/4" allen head screws, torqued to 12.5 ft-lbs.
11. Install bail clamp by placing legs of bail clamp between evaporator and extruder and flip to rear.
12. Place new insulation collar over the extruder, positioning collar so that the bail clamp slides into slots in the insulated collar.
13. Install new ice chute body.
14. Using sweep bolt, hand tighten new ice sweep onto extruder.
15. Place ice chute cover onto the new ice chute body, press down to ensure assembly is properly seated to prevent leaks, and secure with bail clamp.
16. Reinstall panels.
17. Restore power to machine and turn machine on to resume making ice.

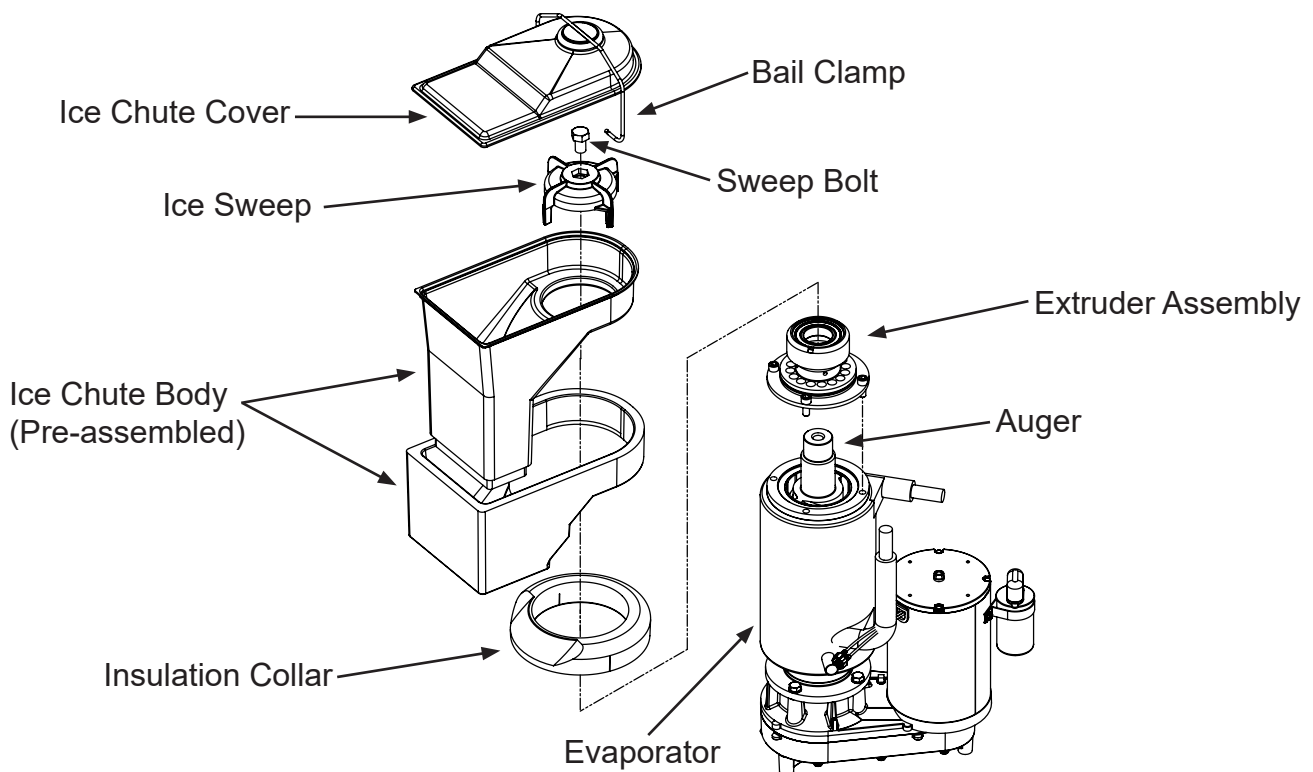

---

**Conversion Kit Contents:**

---

**Conversion Kit: Soft Nugget (A40991-031)**

Extruder Assembly	A40991-021
Ice Sweep	02-5071-01
Ice Chute Body	02-5072-01, 02-5086-01 (pre-assembled)
Insulation Collar	13-0929-02 (black)

**Conversion Kit: Hard Nugget (A40991-033)**

Extruder Assembly	A40991-023, 02-5049-01, 13-0617-52, 13-0617-45, (4) 03-1544-08 (pre-assembled)
Ice Sweep	02-5071-02
Ice Chute Body	02-5072-02, 02-5086-02 (pre-assembled)
Insulation Collar	13-0929-03 (grey)

**Conversion Kit: Flake Ice (A40991-032)**

Extruder Assembly	A40991-022, 02-2916-01, 03-0617-52, 03-0617-49, (4) 03-1403-27, (4) 03-1408-36 (pre-assembled)
Ice Sweep	02-5071-01
Ice Chute Body	02-5072-01, 02-5086-01 (pre-assembled)
Insulation Collar	13-0929-01 (white)

Conversion kits fit all Prodigy Plus flaker and nugget units manufactured August 2020 or later (NH, NS, and FS models)