

---

# Instructions

---

## for the installation of nugget ice diverting kit, KNUGDIV

The kit is used when dispensing nugget ice from an ID150, ID200 or ID250 ice dispenser or equivalent Cornelius ice and beverage dispenser. It is designed to **divert** the nugget ice into the dispenser's chute. Follow these instructions to install the diverting plate onto the dispenser.

Kit contents: diverting plate, RTV sealant.

1. Remove or melt all ice from the dispenser. Check agitator, replace it if it is bent or deformed.
2. Disconnect dispenser from electrical power.

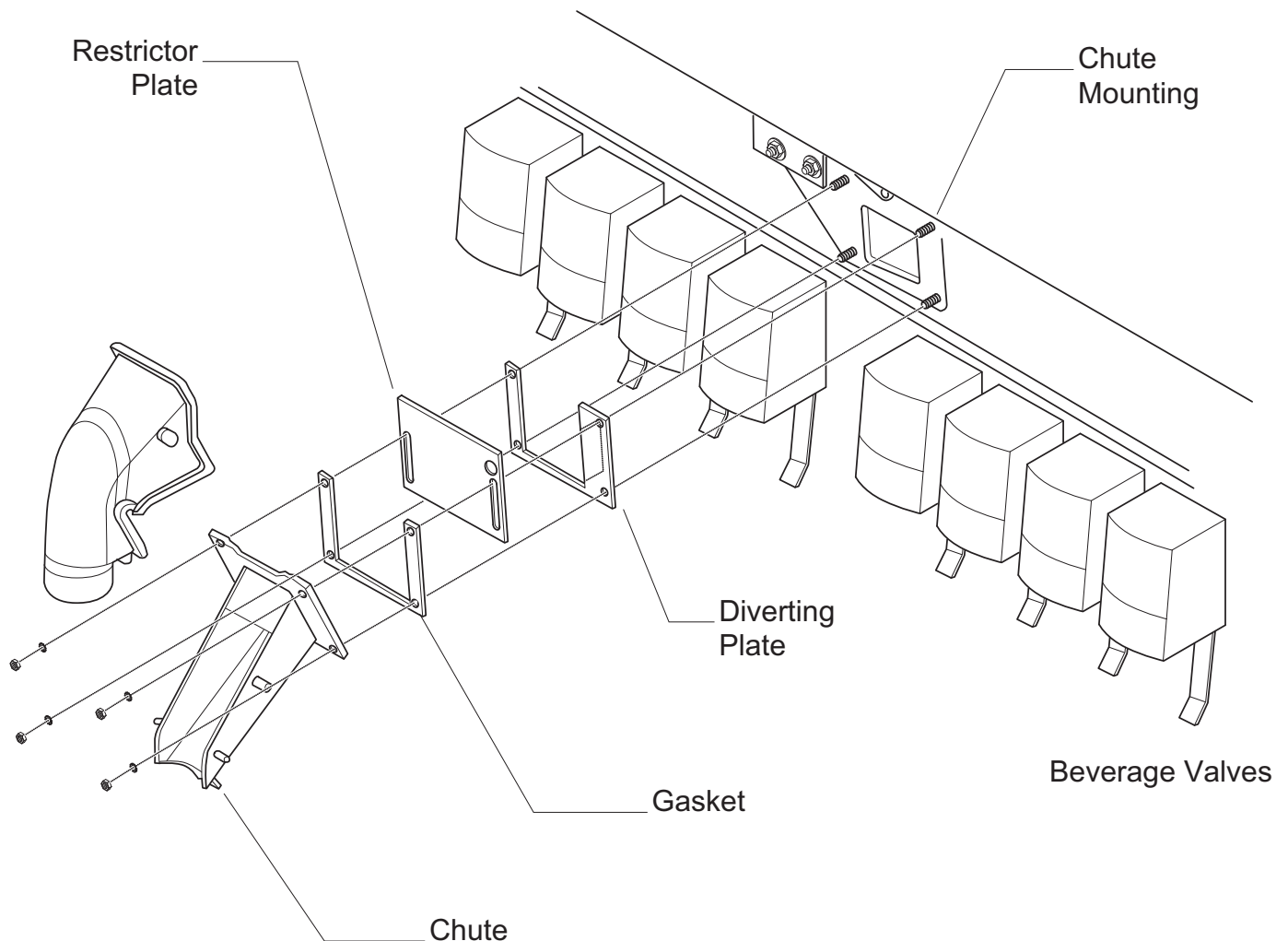

3. Remove merchandiser or stainless cover from upper front of dispenser.
4. Remove four hex nuts holding chute to dispenser, using a 3/8" nut driver or socket.
5. Remove chute from dispenser.
6. Apply a very thin bead of RTV to the back of the diverter mounting plate.
7. Place ice diverter plate onto the four mounting studs on the dispenser.

---

**Note: Flange of diverting plate extends into storage hopper.**

---

8. Position restrictor plate over diverting plate, adjust so that at least 1 1/2" inches of space is open below the bottom edge. Full open will provide maximum ice flow, any less than 1 1/2" will restrict ice.

9. Reinstall gasket and ice chute. Do NOT overtighten nuts.

10. Open front of electrical cover of dispenser, locate circuit board. Adjust motor on time to a half second, adjust off time between agitation to every 3 hours.

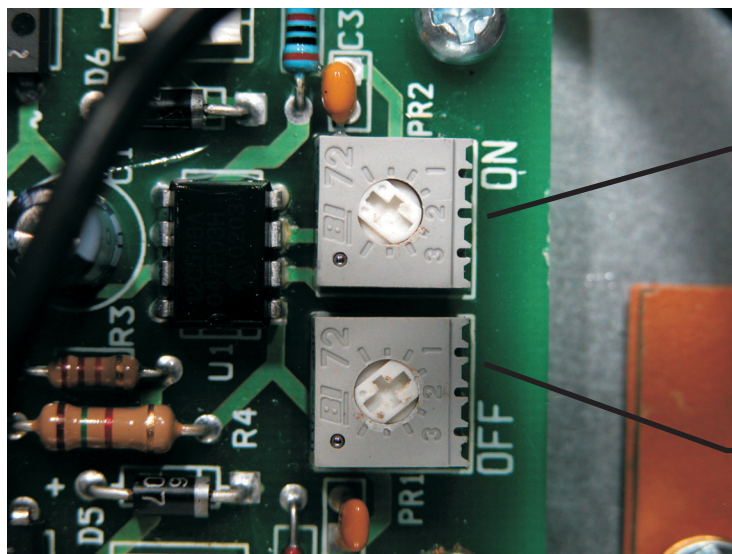
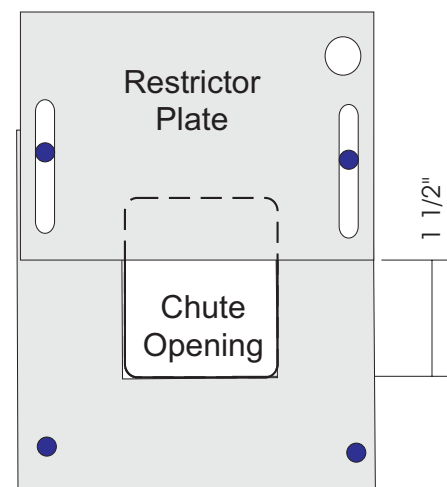

Set full  
CCW\*

Set full CW

11. Reconnect power, agitator should cycle a half second\*. Check ice shutter operation.

12. Return merchandiser or cover to unit.